

DLT RT(M)

Lighting fixture for module or T-profile ceilings

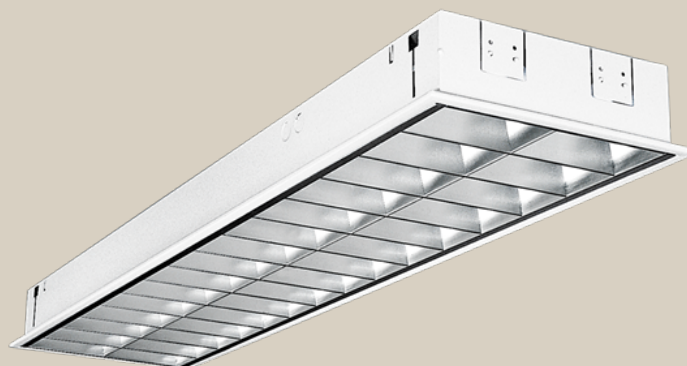

DLT-RT(M) is a recessed luminaire for mounting in exposed T-grid ceilings, ceilings with a concealed supporting grid or plasterboard ceilings. The luminaire can be mounted in fire classified ceilings.

This sturdy luminaire is manufactured with luminaire housing in steel with white epoxy/polyester powder paint. All components are attached to an internal geartray, which can be easily dismantled during maintenance.

DLT-RT(M) is supplied with a wide range of optics and some models can be supplied with integrated emergency light.

Available in twodifferent modules, 300 and 600.

DLT RT(M)

TECHNICAL DESCRIPTION

LIGHT SOURCE

Tubes T26 (T8), 18 or 36W. Lamp base G13

OPTIC

Darklight optic type DL, designed for high quality light distribution.

ELECTRIC

With magnetic ballasts (F) or electronic ballast (HF). Also available with digital dimmable (HFDd) or analogue dimmable (HFDa) ballasts. Variants with emergency battery available on request.

HOUSING

Steel housing with plastic end cap box for lamp holder in one end.

APPLICATION

For recessed installation in T-profile ceilings.

DESIGN

According to maritime requirements

FINISH

Powder coated white RAL9016

MOUNTING

To be mounted in modular panel or solid ceiling.
NB: Side rails and suspension brackets to be ordered separately.

CABLE ENTRY

One double hole 20.5 x 41 mm with rubber grommet on top, two knock outs \varnothing 20,5 on other side of top and two knock outs \varnothing 20,5 on one long side.

Termination: One 3-way + one 2-way push in terminal block, 2 x 2.5mm².

IP CLASSIFICATION

DLT RT(M) products are IP44 under ceiling with an FR1 or FR2 optic in front.

MEASUREMENT DRAWINGS

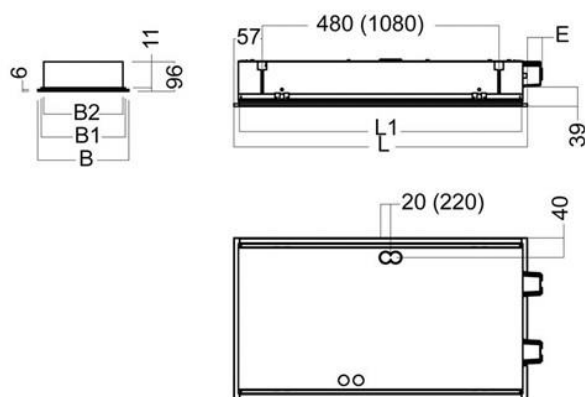

DLT RT(M) DL

DLT RT(M)

EXPLOSION DRAWINGS

